

# 501 SQ.MT. DUPLEX: UNIT A

## GROUND FLOOR PLAN



# 501 SQ.MT. DUPLEX: UNIT A

## BASEMENT PLAN

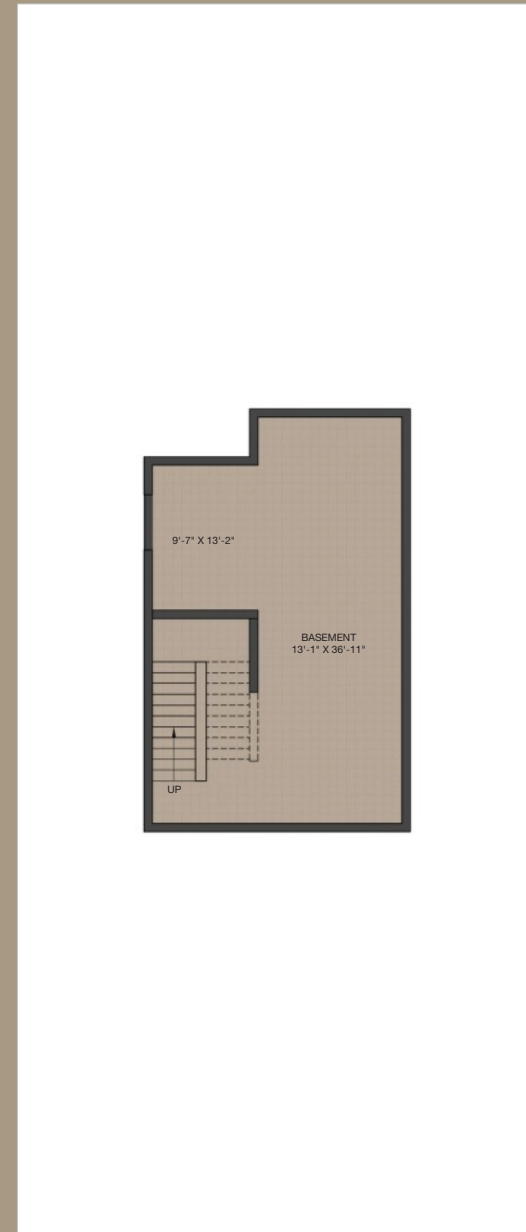

501 SQ.MT. DUPLEX: UNIT B

FIRST FLOOR PLAN



501 SQ.MT. DUPLEX: UNIT B

SECOND FLOOR PLAN



## specifications: 501 sq.mt. duplex villas



RCC FRAMED STRUCTURE WITH CONCRETE MASONRY WALLS DESIGNED WITH SEISMIC CONSIDERATIONS.

STONE CLADDING / TEXTURE PAINT ON EXTERIORS.

LARGE SIZE DOUBLE GLAZED WINDOWS WITH NATURAL / ENGINEERED STONE COPING ON WINDOW SILLS AND PARAPET.

FULLY FITTED VRF AIR-CONDITIONING.

24 HOUR POWER BACKUP.

HOT WATER SUPPLY TO ALL TOILETS & KITCHEN THROUGH CENTRALISED WATER HEATING SYSTEM.

PRESSURISED WATER SUPPLY SYSTEM.

PIPED GAS NETWORK PROVISION.

### LIVING / DINING / FAMILY / PASSAGE

FLOORING	SUPERIOR QUALITY NATURAL / ENGINEERED STONE FLOORING AND SKIRTING
WALLS & CEILING	PLASTIC EMULSION PAINT

### BEDROOMS

FLOORING	SUPERIOR QUALITY NATURAL / ENGINEERED STONE / TIMBER LAMINATED FLOORING AND SKIRTING
WALLS & CEILING	PLASTIC EMULSION PAINT

### KITCHEN

FLOORING	SUPERIOR QUALITY VITRIFIED TILES
WALLS	SUPERIOR QUALITY CERAMIC WALL TILING FROM FLOOR TO CEILING
FITTINGS & FIXTURES	CHROMIUM PLATED FITTINGS, EXHAUST FAN & HOT WATER SUPPLY
UTILITY AREA	SUPERIOR QUALITY CERAMIC TILE FLOORING, SUPERIOR QUALITY CERAMIC WALL TILING UP TO FALSE CEILING & GRANITE COUNTER WITH SINK

### BALCONIES\*

FLOORING	SUPERIOR QUALITY ANTISKID CERAMIC TILE FLOORING AND SKIRTING
PARAPET / RAILING	NATURAL / ENGINEERED STONE COPING / GLASS / SS

## BATHROOMS / TOILETS

WALLS	NATURAL ENGINEERED STONE WALL TILING IN MASTER BATHROOM & SUPERIOR QUALITY CERAMIC WALL TILING UPTO FALSE CEILING IN OTHER BATHROOMS
CEILING	FALSE CEILING / PLASTIC EMULSION PAINT
FLOORING	NATURAL / ENGINEERED STONE FLOORING IN MASTER BATHROOM & SUPERIOR QUALITY ANTISKID CERAMIC TILE FLOORING IN OTHER BATHROOMS
COUNTER	NATURAL / ENGINEERED STONE
FIXTURES	WASH BASIN COUNTER-TOP, SHOWER PARTITION WITH PANEL IN ALL BATHROOMS
ACCESSORIES	EXHAUST FAN, TOWEL RAIL, TOILET PAPER HOLDER IN ALL TOILETS
FITTINGS	FITTINGS OF REPUTABLE MAKE

## DOORS

MAIN DOOR	TIMBER FRAME, TIMBER ARCHITRAVE & SHUTTER DOORS WITH MASONITE SKIN ON BOTH SIDES
BEDROOM DOORS	TIMBER FRAME, TIMBER ARCHITRAVE & SHUTTER DOORS WITH MASONITE SKIN ON BOTH SIDES
TOILET DOORS	SHUTTERS WITH OUTSIDE MASONITE & INSIDE LAMINATE TIMBER FRAME & ARCHITRAVE
EXTERNAL DOORS	SPECIALLY DESIGNED HEAVY-DUTY POWDER COATED ALUMINIUM EXTRUDED FRAMES
WINDOWS	HEAVY-DUTY POWDER COATED ALUMINIUM WINDOWS & VENTILATORS

## STAIRCASE

INTERNAL STAIRCASE	SUPERIOR QUALITY NATURAL / ENGINEERED STONE TREADS AND RISERS GLASS WITH SS / WOODEN RAILING
EXTERNAL STAIRCASE (COMMON)	M.S STAIRCASE WITH NATURAL / ENGINEERED STONE TREADS

## UTILITY ROOM

FLOORING	SUPERIOR QUALITY CERAMIC TILE FLOORING AND SKIRTING
WALLS & CEILING	PLASTIC EMULSION PAINT FOR WALLS AND CEILING
TOILET	SUPERIOR QUALITY ANTISKID CERAMIC TILE FLOORING & SUPERIOR QUALITY CERAMIC WALL TILING UP TO FALSE CEILING. STANDARD SANITARY WARE AND FITTINGS

## TERRACES

TERRACES WITH TILE FLOORING

## BASEMENT\*

FLOORING	SUPERIOR QUALITY VITRIFIED TILE FLOORING AND SKIRTING
WALLS & CEILING	PLASTIC EMULSION PAINT FOR WALLS AND CEILING

## SECURITY

VIDEO DOOR PHONE, SECURED COMMUNITY WITH ACCESS CONTROL AT ENTRANCE. EACH UNIT LINKED TO MAIN SECURITY VIA INTERCOM

## CAR PARKING

2 OPEN CAR PARKS FOR EACH UNIT

## LANDSCAPE

DESIGNER LANDSCAPING

Disclaimer: Marble/granite being natural materials have inherent characteristics of color and grain variations. Utility/S. Room shall not be provided with air conditioning and double glass glazing for window. Specifications are indicative and are subject to change as decided by the Company or Competent Authority. Marginal variations may be necessary during construction. The brands of the equipments/appliances are tentative and liable to change at the sole discretion of the Company. Applicant/Allottee shall not have any right to raise objections in this regards. The plot sizes, areas and plans are subject to changes following final statutory approvals and detail design of services. \*as applicable to the unit

This document is conceptual and not a legal offering by the Company for advertising and is to be used for general information only. Any interested party should verify all the information including designs, plans, specifications, facilities, features, payment schedules, terms of sales etc independently with the Company prior to concluding any decision for buying in any of the project. The user of the Brochure confirms that he/ she has not solely relied on this information for making any booking/ purchase in any project of the Company.

The visuals and information contained herein marked as "artistic impression" are artistic impressions being indicative in nature and are for general information purposes only. The visuals contained marked as "generic image" and other visuals /image /photographs are general images and do not have any correlation with the project.

The imagery used on the brochures may not represent actuals or may be indicative of style only. Photographs of interiors, surrounding views and location may not represent actuals or may have been digitally enhanced or altered. These photographs may not represent actuals or may be indicative only. Computer generated images, walkthroughs and render images are the artist's impression and are an indicative of the actual designs. No information given on this brochure creates a warranty or expand the scope of any warranty that cannot be disclaimed under the applicable laws. The information on this brochure is presented as general information and no representation or warranty is expressly or impliedly given as to its accuracy.

While enough care is taken by the Company to ensure that information in the brochure are up to date, accurate and correct, the readers/ users are requested to make an independent enquiry with the Company before relying upon the same. Nothing on the brochure should be misconstrued as advertising, marketing, booking, selling or an offer for sale or invitation to purchase a unit in any project by the Company. The Company is not responsible for the consequences of any action taken by the viewer relying on such material/ information on this brochure without independently verifying with the Company.